

DM

Blank blocks

Hawke DM blank modules are designed to fill spaces within the frame which are not required for services, thus allowing spare capacity for future requirements.

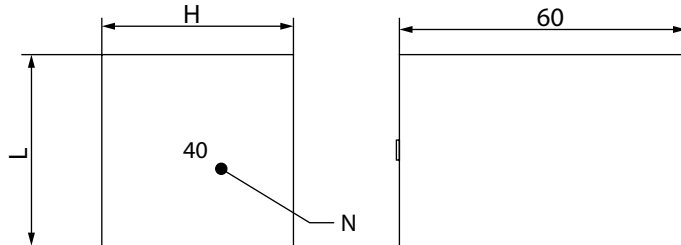

DESCRIPTION	L (mm)	H (mm)	LABEL (N)	WEIGHT (kg)	COLOUR
DM 150	15	15	15	0,01	Black
DM 200	20	20	20	0,02	
DM 300	30	30	30	0,06	
DM 400	40	40	40	0,11	
DM 600	60	60	60	0,22	
DM 50	5	120	-	0,02	
DM 100	10	120	-	0,08	

STAYPLATES

Stayplates ensure the blocks in a Hawke rectangular system (tolerant and blank ones) are fixed in position after compression.

A stayplate should be placed above each complete row of insert/filler blocks, also one stayplate should be installed below the HDM endpacker (already included in CSDM compression kit).

- ◆ Available in AISI 304 stainless steel. AISI 316 and other materials under request.

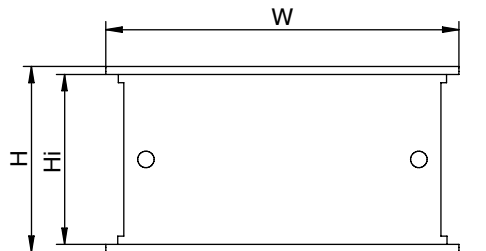

DESCRIPTION	W (mm)	H (mm)	Hi (mm)
Stayplate 931 60mm	68	68	62
Stayplate 931 120mm	128	68	62